



# CP 617 FIRESTOP PUTTY PAD- BOX STRAP INSTALLATION GUIDE

## Notes:

When installing the putty pad:

1. The back box is cleaned
2. Use a retractable knife to cut any excess material
3. Do not stretch the putty pad
4. Seal all the gaps between drywall and the back box

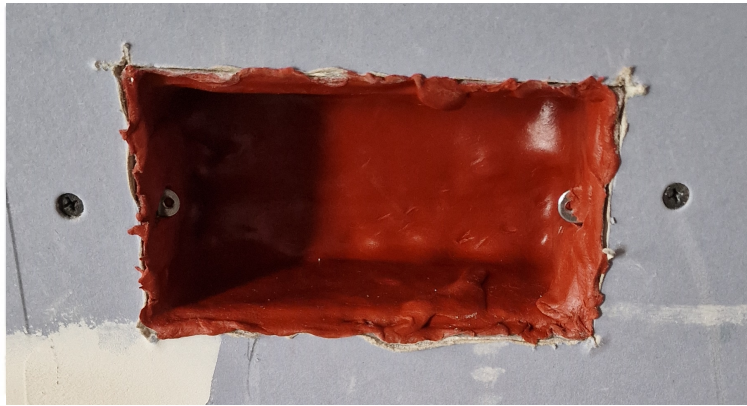

### CP617 putty pad inside the box

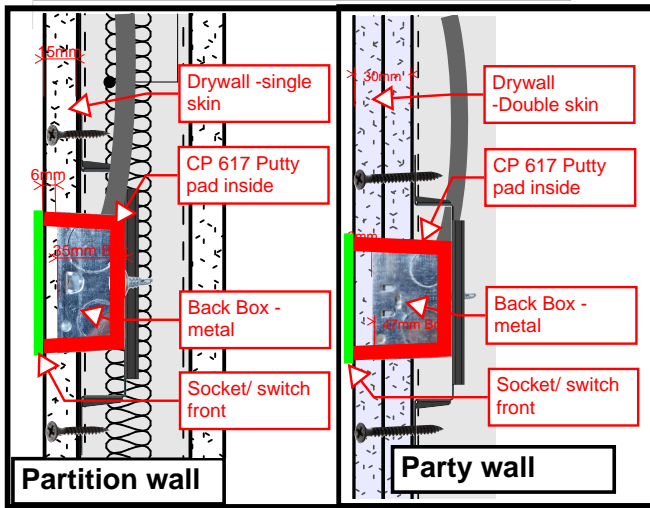

### CP617 putty pad outside the box

