

Recommended Installation Guide

Type of Screws Required



13mm Wafer Head Drywall screw



13mm Wafer Head Jack-point screw



25mm Countersunk cross head



40mm Countersunk cross head

Bracket installation

Double back box

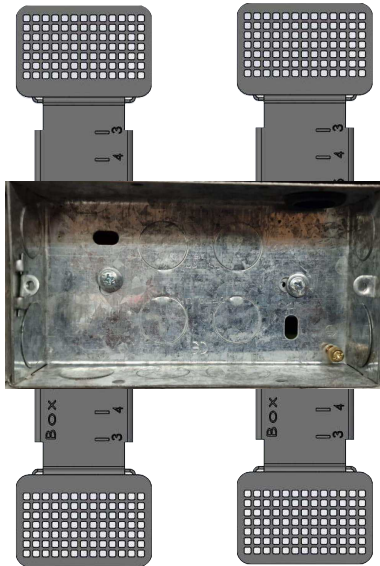

Single back box

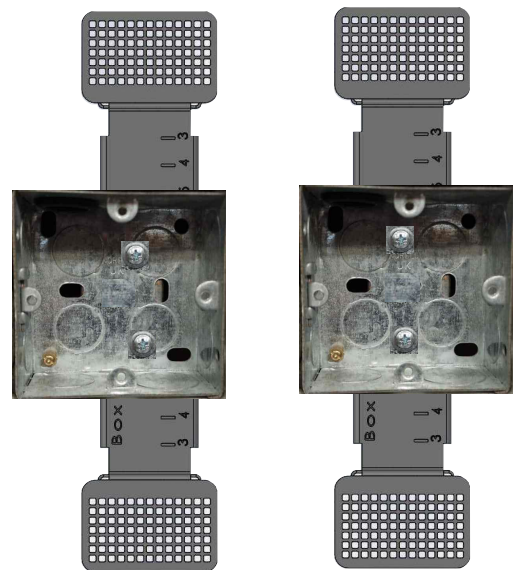

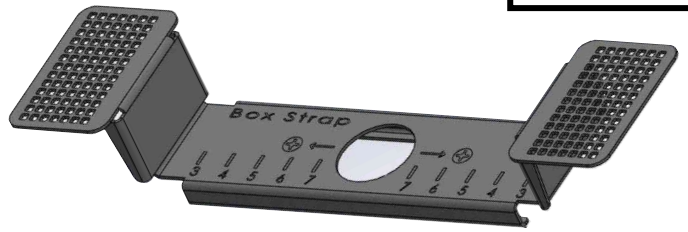

Bracket installation

Kitchen Grid 6g/8g

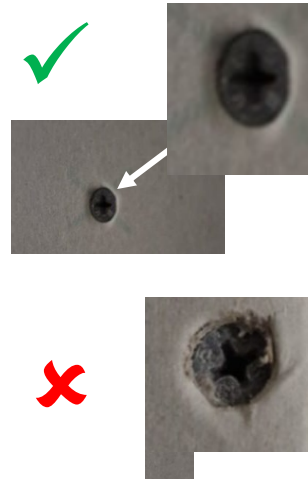
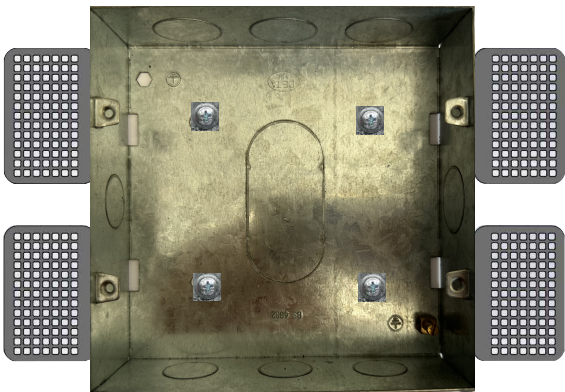

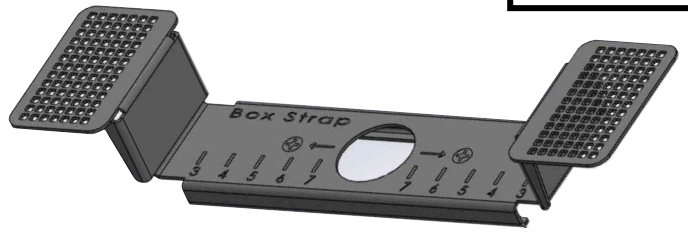

Recommended Installation Guide

Different Wall types at first fix stage

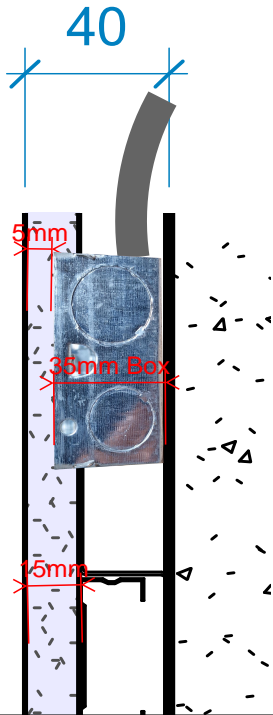

Gyp-liner wall

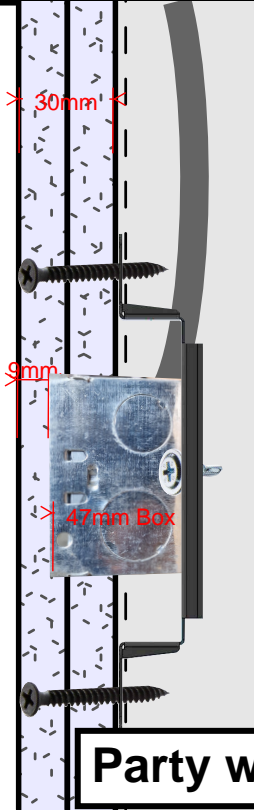

Party wall

Example of the screw head fixing

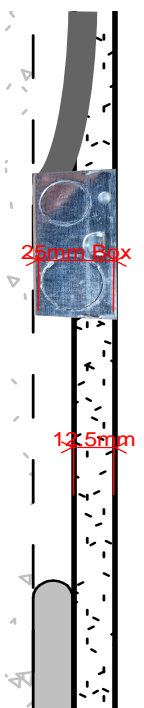
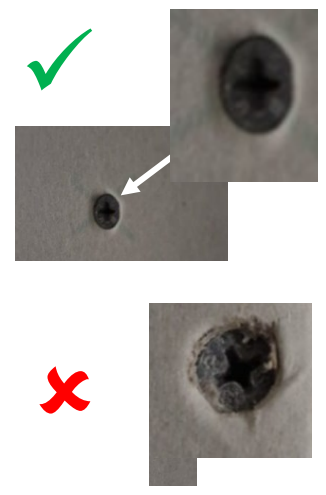

Dot and dab wall

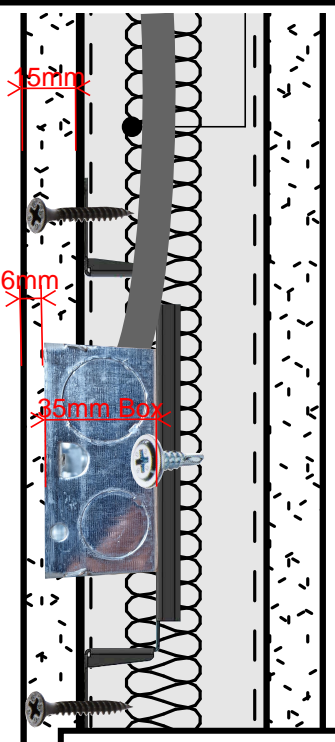

Partition wall

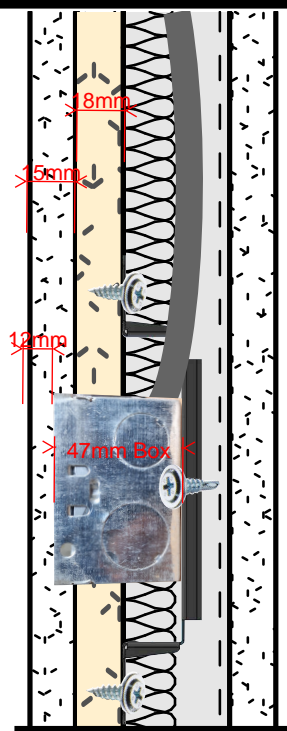

partition wall+ply

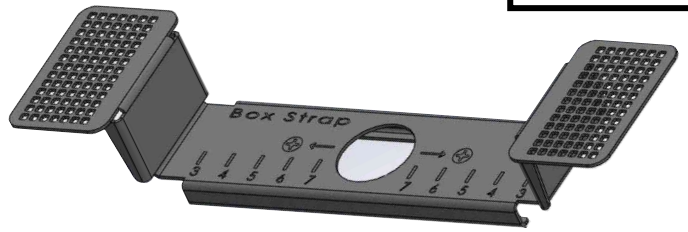

Recommended Installation Guide

Different Wall types at Mid fix stage when both sides of the wall are closed

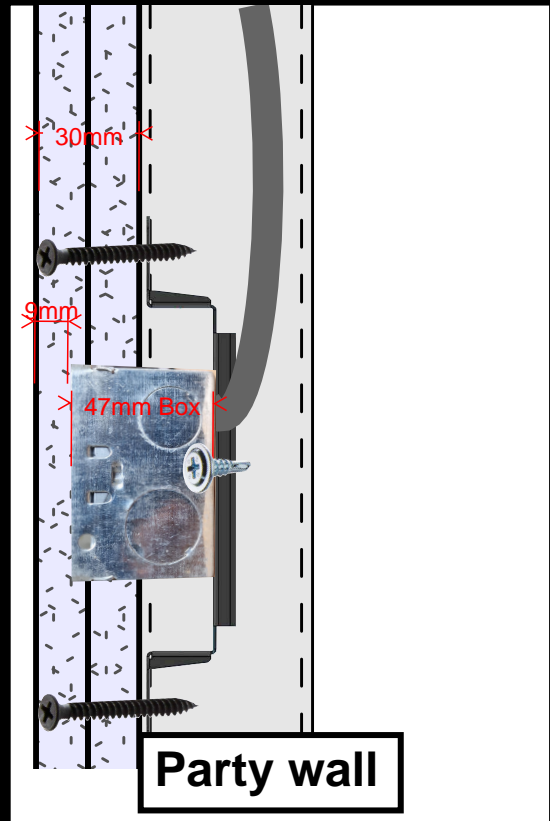

Party wall

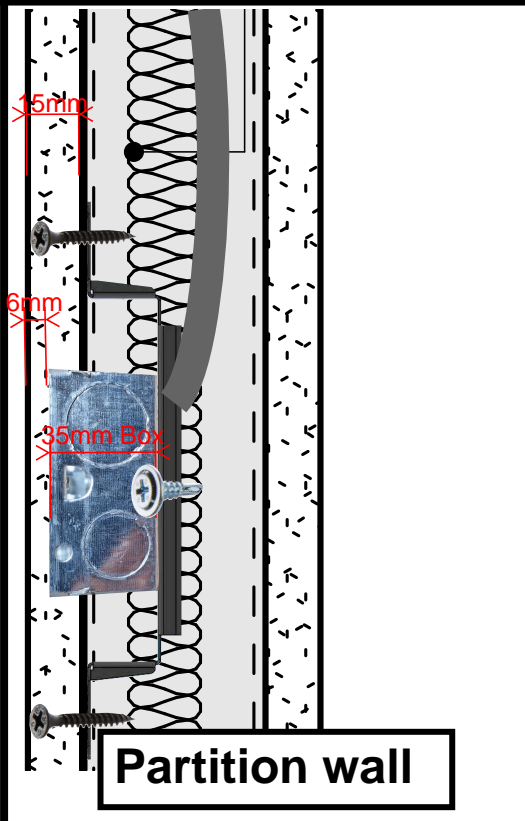

Partition wall

During the return visit to cut out the down-lights and complete back box installation, it is recommended to bring the cables through the back of the box.

Refer to the Project incorporation document for a more comprehensive installation guide

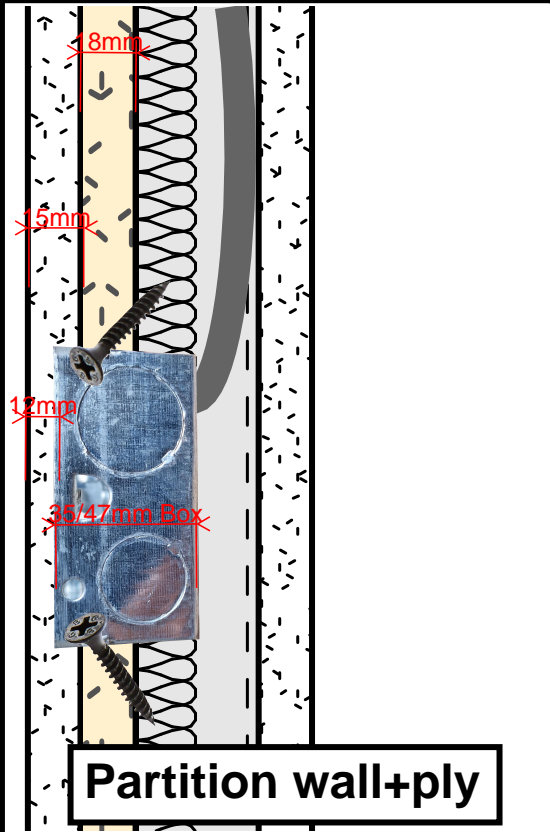

Partition wall+ply

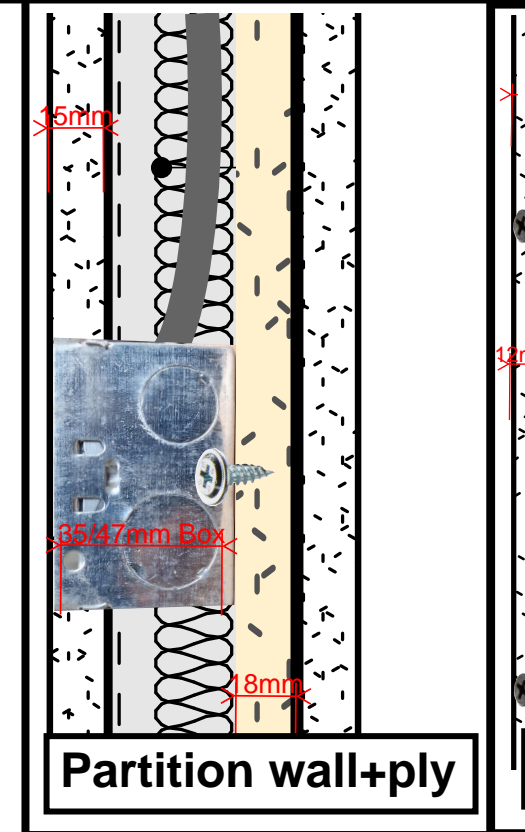

Partition wall+ply

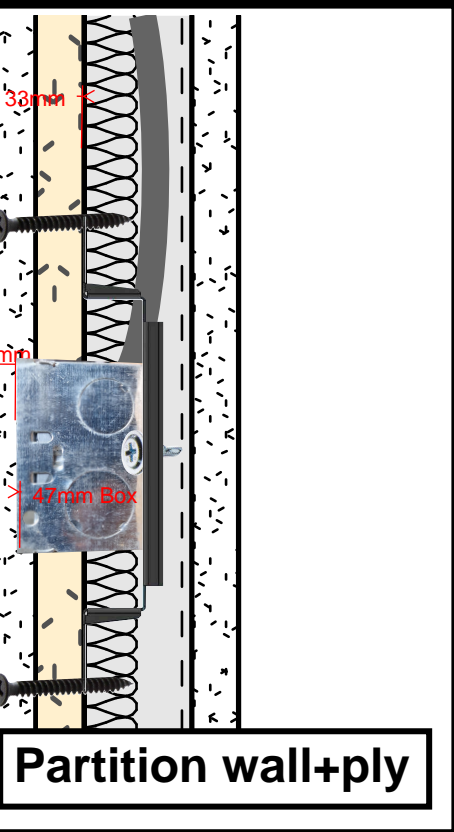

Partition wall+ply